

Soils Map

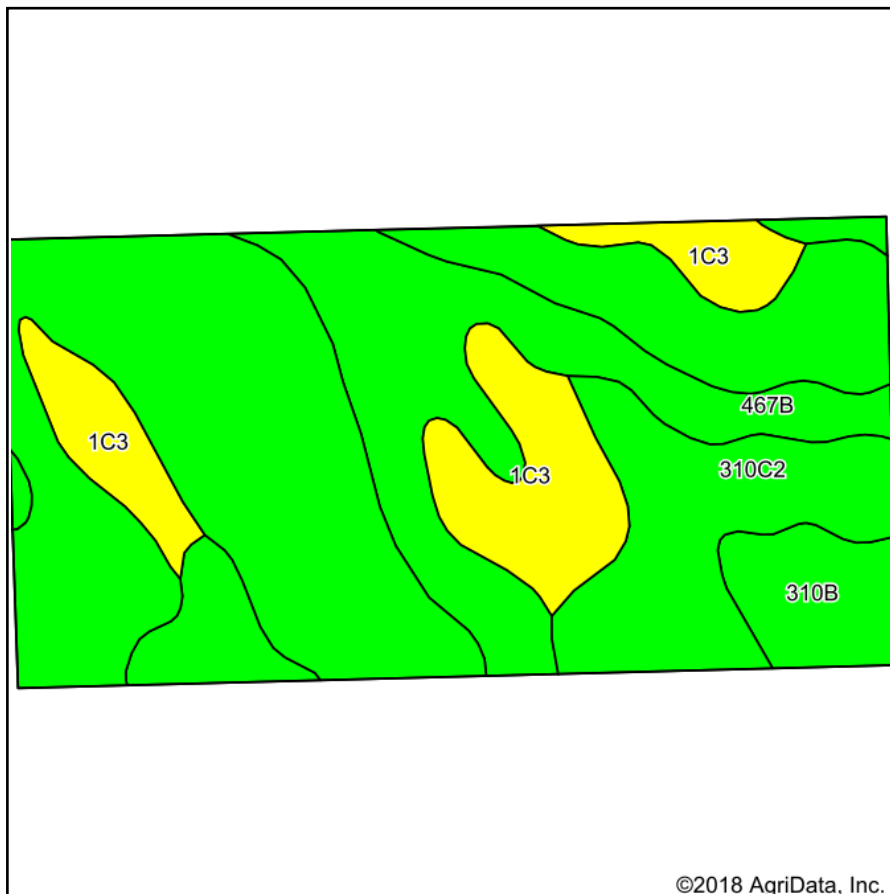

Soils data provided by USDA and NRCS.

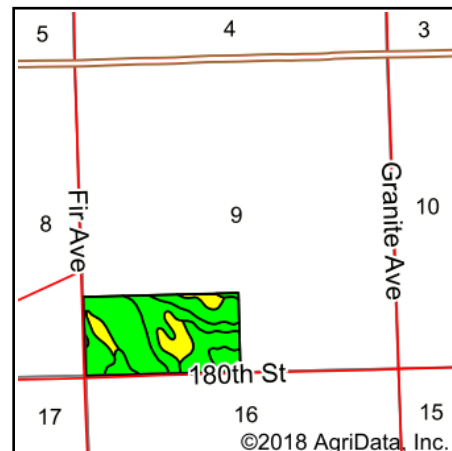

State: **Iowa**
 County: **Plymouth**
 Location: **9-92N-47W**
 Township: **Johnson**
 Acres: **79.38**
 Date: **11/17/2018**



Maps Provided By:
surety
 CUSTOMIZED ONLINE MAPPING
 © AgriData, Inc. 2018 www.AgriDataInc.com



Area Symbol: IA149, Soil Area Version: 29

Code	Soil Description	Acres	Percent of field	CSR2 Legend	Non-Irr Class *c	CSR2**	CSR	*n NCCPI Soybeans
310C2	Galva silty clay loam, 5 to 9 percent slopes, eroded	44.98	56.7%		IIIe	84	51	61
467B	Radford silty clay loam, 2 to 5 percent slopes	14.93	18.8%		Ile	75	72	82
1C3	Ida silt loam, 5 to 9 percent slopes, severely eroded	11.90	15.0%		IIIe	58	44	49
310B	Galva silty clay loam, 2 to 5 percent slopes	7.57	9.5%		Ile	95	68	74
Weighted Average						79.5	55.5	*n 64.4

**IA has updated the CSR values for each county to CSR2.

*n: The aggregation method is "Weighted Average using major components"

*c: Using Capabilities Class Dominant Condition Aggregation Method

Soils data provided by USDA and NRCS.